

BID OF _____

2019

PROPOSAL, CONTRACT, BOND AND SPECIFICATIONS

FOR

DARWIN ROAD RESURFACING WITH UTILITIES ASSESSMENT DISTRICT – 2019

CONTRACT NO. 8124

PROJECT NO. 11746

IN

MADISON, DANE COUNTY, WISCONSIN

AWARDED BY THE COMMON COUNCIL
MADISON, WISCONSIN ON _____

CITY ENGINEERING DIVISION
1600 EMIL STREET
MADISON, WISCONSIN 53713

<https://bidexpress.com/login>

**DARWIN ROAD RESURFACING WITH UTILITIES ASSESSMENT DISTRICT – 2019
CONTRACT NO. 8124**

INDEX

SECTION A: ADVERTISEMENT FOR BIDS AND INSTRUCTIONS TO BIDDERSA-1
SECTION B: PROPOSAL SECTIONB-1
SECTION C: SMALL BUSINESS ENTERPRISE C-1
SECTION D: SPECIAL PROVISIONS..... D-1
SECTION E: BIDDER’S ACKNOWLEDGEMENTE-1
SECTION F: BEST VALUE CONTRACTINGF-1
SECTION G: BID BOND G-1
SECTION H: AGREEMENT H-1
SECTION I: PAYMENT AND PERFORMANCE BONDI-1

This Proposal, and Agreement have
been prepared by:

**CITY ENGINEERING DIVISION
CITY OF MADISON
MADISON, DANE COUNTY, WISCONSIN**



Robert F. Phillips, P.E., City Engineer

RFP: sms

SECTION A: ADVERTISEMENT FOR BIDS AND INSTRUCTIONS TO BIDDERS

REQUEST FOR BID FOR PUBLIC WORKS CONSTRUCTION CITY OF MADISON, WISCONSIN

A BEST VALUE CONTRACTING MUNICIPALITY

| | |
|--|---|
| PROJECT NAME: | DARWIN ROAD RESURFACING WITH UTILITIES ASSESSMENT DISTRICT – 2019 |
| CONTRACT NO.: | 8124 |
| SBE GOAL | 13% |
| BID BOND | 5% |
| SBE PRE BID MEETING (1:00 P.M.) | DECEMBER 14, 2018 |
| PREQUALIFICATION APPLICATION DUE (2:00 P.M.) | DECEMBER 13, 2018 |
| BID SUBMISSION (2:00 P.M.) | DECEMBER 20, 2018 |
| BID OPEN (2:30 P.M.) | DECEMBER 20, 2018 |
| PUBLISHED IN WSJ | DECEMBER 6 & DECEMBER 13, 2018 |

SBE PRE BID MEETING: Representatives of the Affirmative Action Department will be present to discuss the Small Business Enterprise requirements at 1600 Emil Street, Madison Wisconsin.

PREQUALIFICATION APPLICATION: Forms are available on our website, www.cityofmadison.com/business/pw/forms.cfm. If not currently prequalified in the categories listed in Section A, an amendment to your Prequalification will need to be submitted prior to the same due date. Postmark is not applicable.

BIDS TO BE SUBMITTED by hand to 1600 EMIL ST., MADISON, WI 53713 or online at www.bidexpress.com.

THE BID OPENING is at 1600 EMIL ST., MADISON, WI 53713.

STANDARD SPECIFICATIONS

The City of Madison's Standard Specifications for Public Works Construction - 2018 Edition, as supplemented and amended from time to time, forms a part of these contract documents as if attached hereto.

These standard specifications are available on the City of Madison Public Works website, www.cityofmadison.com/Business/PW/specs.cfm.

The Contractor shall review these Specifications prior to preparation of proposals for the work to be done under this contract, with specific attention to Article 102, "BIDDING REQUIREMENTS AND CONDITIONS" and Article 103, "AWARD AND EXECUTION OF THE CONTRACT." For the convenience of the bidder, below are highlights of three subsections of the specifications.

SECTION 102.1: PRE-QUALIFICATION OF BIDDERS

In accordance with Wisconsin State Statutes 66.0901 (2) and (3), all bidders must submit to the Board of Public Works proof of responsibility on forms furnished by the City. The City requires that all bidders be qualified on a biennial basis.

Bidders must present satisfactory evidence that they have been regularly engaged in the type of work specified herein and they are fully prepared with necessary capital, materials, machinery and supervisory personnel to conduct the work to be contracted for to the satisfaction of the City. All bidders must be pre-qualified by the Board of Public Works for the type of construction on which they are bidding prior to the opening of the bid.

In accordance with Section 39.02(9)(a)l. of the General Ordinances, all bidders shall submit in writing to the Affirmative Action Division Manager of the City of Madison, a Certificate of Compliance or an Affirmative Action Plan at the same time or prior to the submission of the proof of responsibility forms.

The bidder shall be disqualified if the bidder fails to or refuses to, prior to opening of the bid, submit a Certificate of compliance, Affirmative Action Plan or Affirmative Action Data Update, as applicable, as defined by Section 39.02 of the General Ordinances (entitled Affirmative Action) and as required by Section 102.11 of the Standard Specifications.

SECTION 102.4 PROPOSAL

No bid will be accepted that does not contain an adequate or reasonable price for each and every item named in the Schedule of Unit Prices.

A lump sum bid for the work in accordance with the plans and specifications is required. The lump sum bid must be the same as the total amounts bid for the various items and it shall be inserted in the space provided.

All papers bound with or attached to the proposal form are considered a part thereof and must not be detached or altered when the proposal is submitted. The plans, specifications and other documents designated in the proposal form will be considered a part of the proposal whether attached or not.

A proposal submitted by an individual shall be signed by the bidder or by a duly authorized agent. A proposal submitted by a partnership shall be signed by a member/partner or by a duly authorized agent thereof. A proposal submitted by a corporation shall be signed by an authorized officer or duly authorized registered agent of such corporation, and the proposal shall show the name of the State under the laws of which such corporation was chartered. The required signatures shall in all cases appear in the space provided thereof on the proposal.

Each proposal shall be placed, together with the proposal guaranty, in a sealed envelope, so marked as to indicate name of project, the contract number or option to which it applies, and the name and address of the Contractor or submitted electronically through Bid Express (www.bidexpress.com). Proposals will be accepted at the location, the time and the date designated in the advertisement. Proposals received after the time and date designated will be returned to the bidder unopened.

SECTION 102.5: BID DEPOSIT (PROPOSAL GUARANTY)

All bids, sealed or electronic, must be accompanied with a Bid Bond equal to at least 5% of the bid or a Certificate of Annual/Biennial Bid Bond or certified check, payable to the City Treasurer. Bid deposit of the successful bidders shall be returned within forty-eight (48) hours following execution of the contract and bond as required.

MINOR DISCREPENCIES

Bidder is responsible for submitting all forms necessary for the City to determine compliance with State and City bidding requirements. Notwithstanding any language to the contrary contained herein, the City may exercise its discretion to allow bidders to correct or supplement submissions after bid opening, if the minor discrepancy, bid irregularity or omission is insignificant and not one related to price, quality, quantity, time of completion or performance of the contract.

Bidders for this Contract(s) must be Pre-Qualified for at least one of the following type(s) of construction denoted by an

Building Demolition

- 101 Asbestos Removal
- 120 House Mover

- 110 Building Demolition

Street, Utility and Site Construction

- 201 Asphalt Paving
- 205 Blasting
- 210 Boring/Pipe Jacking
- 215 Concrete Paving
- 220 Con. Sidewalk/Curb & Gutter/Misc. Flat Work
- 221 Concrete Bases and Other Concrete Work
- 222 Concrete Removal
- 225 Dredging
- 230 Fencing
- 235 Fiber Optic Cable/Conduit Installation
- 240 Grading and Earthwork
- 241 Horizontal Saw Cutting of Sidewalk
- 242 Infrared Seamless Patching
- 245 Landscaping, Maintenance
- 246 Ecological Restoration
- 250 Landscaping, Site and Street
- 251 Parking Ramp Maintenance
- 252 Pavement Marking
- 255 Pavement Sealcoating and Crack Sealing
- 260 Petroleum Above/Below Ground Storage Tank Removal/Installation
- 262 Playground Installer

- 265 Retaining Walls, Precast Modular Units
- 270 Retaining Walls, Reinforced Concrete
- 275 Sanitary, Storm Sewer and Water Main Construction
- 276 Sawcutting
- 280 Sewer Lateral Drain Cleaning/Internal TV Insp.
- 285 Sewer Lining
- 290 Sewer Pipe Bursting
- 295 Soil Borings
- 300 Soil Nailing
- 305 Storm & Sanitary Sewer Laterals & Water Svc.
- 310 Street Construction
- 315 Street Lighting
- 318 Tennis Court Resurfacing
- 320 Traffic Signals
- 325 Traffic Signing & Marking
- 332 Tree pruning/removal
- 333 Tree, pesticide treatment of
- 335 Trucking
- 340 Utility Transmission Lines including Natural Gas, Electrical & Communications
- 399 Other _____

Bridge Construction

- 501 Bridge Construction and/or Repair

Building Construction

- 401 Floor Covering (including carpet, ceramic tile installation, rubber, VCT)
- 402 Building Automation Systems
- 403 Concrete
- 404 Doors and Windows
- 405 Electrical - Power, Lighting & Communications
- 410 Elevator - Lifts
- 412 Fire Suppression
- 413 Furnishings - Furniture and Window Treatments
- 415 General Building Construction, Equal or Less than \$250,000
- 420 General Building Construction, \$250,000 to \$1,500,000
- 425 General Building Construction, Over \$1,500,000
- 428 Glass and/or Glazing
- 429 Hazardous Material Removal
- 430 Heating, Ventilating and Air Conditioning (HVAC)
- 433 Insulation - Thermal
- 435 Masonry/Tuck pointing

- 437 Metals
- 440 Painting and Wallcovering
- 445 Plumbing
- 450 Pump Repair
- 455 Pump Systems
- 460 Roofing and Moisture Protection
- 464 Tower Crane Operator
- 461 Solar Photovoltaic/Hot Water Systems
- 465 Soil/Groundwater Remediation
- 466 Warning Sirens
- 470 Water Supply Elevated Tanks
- 475 Water Supply Wells
- 480 Wood, Plastics & Composites - Structural & Architectural
- 499 Other _____

State of Wisconsin Certifications

- 1 Class 5 Blaster - Blasting Operations and Activities 2500 feet and closer to inhabited buildings for quarries, open pits and road cuts.
- 2 Class 6 Blaster - Blasting Operations and Activities 2500 feet and closer to inhabited buildings for trenches, site excavations, basements, underwater demolition, underground excavations, or structures 15 feet or less in height.
- 3 Class 7 Blaster - Blasting Operations and Activities for structures greater than 15 ' in height, bridges, towers, and any of the objects or purposes listed as "Class 5 Blaster or Class 6 Blaster".
- 4 Petroleum Above/Below Ground Storage Tank Removal and Installation (Attach copies of State Certifications.)
- 5 Hazardous Material Removal (Contractor to be certified for asbestos and lead abatement per the Wisconsin Department of Health Services, Asbestos and Lead Section (A&LS).) See the following link for application: www.dhs.wisconsin.gov/Asbestos/Cert. State of Wisconsin Performance of Asbestos Abatement Certificate must be attached.
- 6 Certification number as a Certified Arborist or Certified Tree Worker as administered by the International Society of Arboriculture
- 7 Pesticide application (Certification for Commercial Applicator For Hire with the certification in the category of turf and landscape (3.0) and possess a current license issued by the DATCP)
- 8 State of Wisconsin Master Plumbers License.

SECTION B: PROPOSAL

Please refer to the
Bid Express Website
at <https://bidexpress.com>
look up contract number
and go to
Section B: Proposal Page

You can access all City of Madison bid solicitations for FREE at www.bidexpress.com

Click on the “Register for Free” button and follow the instructions to register your company and yourself. You will be asked for a payment subscription preference, since you may wish to bid online someday. Simply choose the method to pay on a ‘per bid’ basis. This requires no payment until / unless you actually bid online. You can also choose the monthly subscription plan at this time. You will, however, be asked to provide payment information. Remember, you can change your preference at anytime. You will then be able to complete your free registration and have full access to the site. Your free access does not require completion of the ‘Digital ID’ process, so you will have instant access for viewing and downloading. To be prepared in case you ever do wish to bid online, you may wish to establish your digital ID also, since you cannot bid without a Digital ID.

If you have any problems with the free registration process, you can call the bidexpress help team, toll free at 1-888-352-2439 (option 1, option1).

SECTION C: SMALL BUSINESS ENTERPRISE

Instructions to Bidders City of Madison SBE Program Information

2 Small Business Enterprise (SBE) Program Information

2.1 Policy and Goal

The City of Madison reaffirms its policy of nondiscrimination in the conduct of City business by maintaining a procurement process which remains open to all who have the potential and ability to sell goods and services to the City. It is the policy of the City of Madison to allow Small Business Enterprises (SBE) maximum feasible opportunity to participate in City of Madison contracting. The bidder acknowledges that its bid has been submitted in accordance with the SBE program and is for the public's protection and welfare.

Please refer to the "ADVERTISEMENT FOR BIDS" for the goal for the utilization of SBEs on this project. SBEs may participate as subcontractors, vendors and/or suppliers, which provide a commercially useful function. The dollar value for SBE suppliers or 'materials only' vendors shall be discounted to 60% for purposes of meeting SBE goals.

A bidder which achieves or exceeds the SBE goal will be in compliance with the SBE requirements of this project. In the event that the bidder is unable to achieve the SBE goal, the bidder must demonstrate that a good faith effort to do so was made. Failure to either achieve the goal or demonstrate a good faith effort to do so will be grounds for the bidder being deemed a non-responsible contractor ineligible for award of this contract.

A bidder may count towards its attainment of the SBE goal only those expenditures to SBEs that perform a commercially useful function. For purposes of evaluating a bidder's responsiveness to the attainment of the SBE goal, the contract participation by an SBE is based on the percentage of the total base bid proposed by the Contractor. The total base bid price is inclusive of all addenda.

Work performed by an SBE firm in a particular transaction can be counted toward the goal only if it involves a commercially useful function. That is, in light of industry practices and other relevant considerations, does the SBE firm have a necessary and useful role in the transaction, of a kind for which there is a market outside the context of the SBE Program, or is the firm's role a superfluous step added in an attempt to obtain credit towards goals? If, in the judgment of the Affirmative Action Division, the SBE firm will not perform a commercially useful function in the transaction, no credit towards goals will be awarded.

The question of whether a firm is performing a commercially useful function is completely separate from the question of whether the firm is an eligible SBE. A firm is eligible if it meets the definitional criteria and ownership and control requirements, as set forth in the City of Madison's SBE Program.

If the City of Madison determines that the SBE firm is performing a commercially useful function, then the City of Madison must then decide what that function is. If the commercially useful function is that of an SBE vendor / supplier that regularly transacts business with the respective product, then the City of Madison will count 60% of the value of the product supplied toward SBE goals.

To be counted, the SBE vendor / supplier must be engaged in selling the product in question to the public. This is important in distinguishing an SBE vendor / supplier, which has a regular trade with a variety of customers, from a firm which performs supplier-like functions on an ad hoc basis or for only one or two contractors with whom it has a special relationship.

A supplier of bulk goods may qualify as an eligible SBE vendor / supplier if it either maintains an inventory or owns or operates distribution equipment. With respect to the distribution equipment; e.g., a fleet of trucks, the term "operates" is intended to cover a situation in which the supplier leases the equipment on a regular basis for its entire business. It is not intended to cover a situation in which the firm simply provides drivers for trucks owned or leased by another party; e.g., a prime contractor, or leases such a party's trucks on an ad hoc basis for a specific job.

If the commercially useful function being performed is not that of a qualified SBE vendor / supplier, but rather that of delivery of products, obtaining bonding or insurance, procurement of personnel, acting as a broker or manufacturer's representative in the procurement of supplies, facilities, or materials, etc., only the fees or commissions will apply towards the goal.

For example, a business that simply transfers title of a product from manufacturer to ultimate purchaser; e. g., a sales representative who re-invoices a steel product from the steel company to the Contractor, or a firm that puts a product into a container for delivery would not be considered a qualified SBE vendor / supplier. The Contractor would not receive credit based on a percentage of the cost of the product for working with such firms.

Concerning the use of services that help the Contractor obtain needed supplies, personnel, materials or equipment to perform a contract: only the fee received by the service provider will be counted toward the goal. For example, use of a SBE sales representative or distributor for a steel company, if performing a commercially useful function at all, would entitle the Contractor receiving the steel to count only the fee paid to the representative or distributor toward the goal. This provision would also govern fees for professional and other services obtained expressly and solely to perform work relating to a specific contract.

Concerning transportation or delivery services: if an SBE trucking company picks up a product from a manufacturer or a qualified vendor / supplier and delivers the product to the Contractor, the commercially useful function it is performing is not that of a supplier, but simply that of a transporter of goods. Unless the trucking company is itself the manufacturer or a qualified vendor / supplier in the product, credit cannot be given based on a percentage of the cost of the product. Rather, credit would be allowed for the cost of the transportation service.

The City is aware that the rule's language does not explicitly mention every kind of business that may contribute work on this project. In administering these programs, the City would, on a case-by-case basis, determine the appropriate counting formula to apply in a particular situation.

2.2 Contract Compliance

Questions concerning the SBE Program shall be directed to the Contract Compliance Officer of the City of Madison Department of Civil Rights, Affirmative Action Division, 210 Martin Luther King, Jr. Blvd., Room 523, Madison, WI 53703; telephone (608) 266-4910.

2.3 Certification of SBE by City of Madison

The Affirmative Action Division maintains a directory of SBEs which are currently certified as such by the City of Madison. Contact the Contract Compliance Officer as indicated in Section 2.2 to receive a copy of the SBE Directory or you may access the SBE Directory online at www.cityofmadison.com/dcr/aaTBDDir.cfm.

All contractors, subcontractors, vendors and suppliers seeking SBE status must complete and submit the **Targeted Business Certification Application** to the City of Madison Affirmative Action Division by the time and date established for receipt of bids. A copy of the Targeted Business Certification Application is available by contacting the Contract Compliance Officer at the address and telephone indicated in Section 2.2 or you may access the Targeted Business Certification Application online at www.cityofmadison.com/dcr/aaTBDDir.cfm. Submittal of the Targeted Business Certification Application by the time specified does not guarantee that the applicant will be certified as a SBE eligible to be utilized towards meeting the SBE goal for this project.

2.4 Small Business Enterprise Compliance Report

2.4.1 Good Faith Efforts

Bidders shall take all necessary affirmative steps to assure that SBEs are utilized when possible and that the established SBE goal for this project is achieved. A contractor who self performs a portion of the work, and is pre-qualified to perform that category of work, may subcontract that portion of the work, but shall not be required to do so. When a bidder is unable to achieve the established SBE goal, the bidder must demonstrate that a good faith effort to do so was made. Such a good faith effort should include the following:

- 2.4.1.1 Attendance at the pre-bid meeting.
- 2.4.1.2 Using the City of Madison's directory of certified SBEs to identify SBEs from which to solicit bids.
- 2.4.1.3 Assuring that SBEs are solicited whenever they are potential sources.
- 2.4.1.4 Referring prospective SBEs to the City of Madison Affirmative Action Division for certification.
- 2.4.1.5 Dividing total project requirements into smaller tasks and/or quantities, where economically feasible, to permit maximum feasible SBE participation.
- 2.4.1.6 Establishing delivery schedules, where requirements permit, which will encourage participation by SBEs.
- 2.4.1.7 Providing SBEs with specific information regarding the work to be performed.
- 2.4.1.8 Contacting SBEs in advance of the deadline to allow such businesses sufficient time to prepare a bid.
- 2.4.1.9 Utilizing the bid of a qualified and competent SBE when the bid of such a business is deemed reasonable (i.e. 5% above the lowest bidder), although not necessarily low.
- 2.4.1.10 Contacting SBEs which submit a bid, to inquire about the details of the bid and confirm that the scope of the work was interpreted as intended.
- 2.4.1.11 Completion of Cover Page (page C-6), Summary Sheet (page C-7) and SBE Contact Reports (pages C-8 and C9) if applicable.

2.4.2 Reporting SBE Utilization and Good Faith Efforts

The Small Business Enterprise Compliance Report is to be submitted by the bidder with the bid: This report is due by the specified bid closing time and date. Bids submitted without a completed SBE Compliance Report as outlined below may be deemed non-responsible and the bidder ineligible for award of this contract. Notwithstanding any language to the contrary contained herein, the City may exercise its discretion to allow bidders to correct or supplement submissions after bid opening, if the minor discrepancy, bid irregularity or omission is insignificant and not one related to price, quality, quantity, time of completion, performance of the contract, or percentage of SBE utilization.

2.4.2.1 If the Bidder meets or exceeds the goal established for SBE utilization, the Small Business Enterprise Compliance Report shall consist of the following:

- 2.4.2.1.1 **Cover Page**, Page C-6; and
- 2.4.2.1.2 **Summary Sheet**, C-7.

2.4.2.2 If the bidder does not meet the goal established for SBE utilization, the Small Business Enterprise Compliance Report shall consist of the following:

- 2.4.2.2.1 **Cover Page**, Page C-6;
- 2.4.2.2.2 **Summary Sheet**, C-7; and
- 2.4.2.2.3 **SBE Contact Report**, C-8 and C-9. (A separate Contact Report must be completed for each applicable SBE which is not utilized.)

2.5 Appeal Procedure

A bidder which does not achieve the established goal and is found non-responsible for failure to demonstrate a good faith effort to achieve such goal and subsequently denied eligibility for award of contract may appeal that decision to the Small Business Enterprises Appeals Committee. All appeals shall be made in writing, and shall be delivered to and received by the City Engineer no later than 4:30 PM on the third business day following the bidder's receipt of the written notification of ineligibility by the Affirmative Action Division Manager. Postmark not acceptable. The notice of appeal shall state the basis for the appeal of the decision of the Affirmative Action Division Manager. The Appeal shall take place in accordance with Madison General Ordinance 33.54.

2.6 SBE Requirements After Award of the Contract

The successful bidder shall identify SBE subcontractors, suppliers and vendors on the subcontractor list in accordance with the specifications. The Contractor shall submit a detailed explanation of any variances between the listing of SBE subcontractors, vendors and/or suppliers on the subcontractor list and the Contractor's SBE Compliance Report for SBE participation.

No change in SBE subcontractors, vendors and/or suppliers from those SBEs indicated in the SBE Compliance Report will be allowed without prior approval from the Engineer and the Affirmative Action Division. The contractor shall submit in writing to the City of Madison Affirmative Action Division a request to change any SBE citing specific reasons which necessitate such a change. The Affirmative Action Division will use a general test of reasonableness in approving or rejecting the contractor's request for change. If the request is approved, the Contractor will make every effort to utilize another SBE if available.

The City will monitor the project to ensure that the actual percentage commitment to SBE firms is carried out.

2.7 SBE Definition and Eligibility Guidelines

A Small Business Enterprise is a business concern awarded certification by the City of Madison. For the purposes of this program a Small Business Enterprise is defined as:

- A. An independent business operated under a single management. The business may not be a subsidiary of any other business and the stock or ownership may not be held by any individual or any business operating in the same or a similar field. In determining whether an entity qualifies as a SBE, the City shall consider all factors relevant to being an independent business including, but not limited to, the date the business was established, adequacy of its resources for the work in which it proposes to involve itself, the degree to which financial, equipment leasing and other relationships exist with other ineligible firms in the same or similar lines of work. SBE owner(s) shall enjoy the customary incidents of ownership and shall share in the risks and profits commensurate with their enjoyment interests, as demonstrated by an examination of the substance rather than form or arrangements that may be reflected in its ownership documents.
- B. A business that has averaged no more than \$4.0 million in annual gross receipts over the prior three year period and the principal owner(s) do not have a personal net worth in excess of \$1.32 million.

Firm and/or individuals that submit fraudulent documents/testimony may be barred from doing business with the City and/or forfeit existing contracts.

SBE certification is valid for one (1) year unless revoked.

**DARWIN ROAD RESURFACING WITH UTILITIES ASSESSMENT DISTRICT – 2019
CONTRACT NO. 8124**

Small Business Enterprise Compliance Report

**This information may be submitted electronically through
Bid Express or submitted with bid in sealed envelope.**

Cover Sheet

Prime Bidder Information

Company: _____

Address: _____

Telephone Number: _____ Fax Number: _____

Contact Person/Title: _____

Prime Bidder Certification

I, _____, _____ of
Name Title

_____ certify that the information
Company

contained in this SBE Compliance Report is true and correct to the best of my knowledge and belief.

Witness' Signature

Bidder's Signature

Date

**DARWIN ROAD RESURFACING WITH UTILITIES ASSESSMENT DISTRICT – 2019
CONTRACT NO. 8124**

Small Business Enterprise Compliance Report

SBE Contact Report

Submit separate copy of this form for each SBE which you are not able to utilize towards meeting the SBE goal for this project. Attach separate sheets if necessary.

SBE Information

Company: _____

Address: _____

Telephone Number: _____

Contact Person/Title: _____

1. Outline below all efforts to solicit a bid from the above SBE. Include date, means of contact, who from your company made this contact and the result.

2. Describe the information provided to the aforementioned SBE regarding the scope of work for which he/she was to provide a bid.

Is this the same scope of work on which the subcontractor you intend to utilize based his/her bid?

Yes No

3. Did this SBE submit a bid? Yes No

4. Is the General Contractor pre-qualified to self-perform this category of work?

Yes No

5. If you responded "Yes" to Question 3, please check the items below which apply and provide the requested detail. If you responded "No" to Question 3, please skip ahead to item 6 below.

The SBE listed above is unavailable for work on this project for the following reasons. Provide specific detail for this conclusion.

The SBE listed above is unqualified for work on this project. Provide specific details for this conclusion.

The SBE listed above provided a price that was unreasonable (i.e. more than 5% above the lowest bidder). Provide specific detail for this conclusion including the SBE's price and the price of the subcontractor you intend to utilize.

A contract with the SBE listed above may constitute a breach of the bidder's collective bargaining agreements. Provide specific detail for this conclusion including, but not limited to, correspondence from the SBE indicating it will not sign a project labor agreement and/or correspondence from the applicable trade union indicating a project labor agreement will not be allowed at the time of project bidding.

Other; please specify reason(s) other than listed above which made it impossible for you to utilize this SBE on this project.

6. Describe any other good faith efforts:

SECTION D: SPECIAL PROVISIONS

DARWIN ROAD RESURFACING WITH UTILITIES ASSESSMENT DISTRICT – 2019 CONTRACT NO. 8124

It is the intent of these Special Provisions to set forth the final contractual intent as to the matter involved and shall prevail over the Standard Specifications and plans whenever in conflict therewith. In order that comparisons between the Special Provisions can be readily made, the numbering system for the Special Provisions is equivalent to that of the Specifications.

Whenever in these Specifications the term “Standard Specifications” appears, it shall be taken to refer to the City of Madison Standard Specifications for Public Works Construction and Supplements thereto.

SECTION 102.11: BEST VALUE CONTRACTING

This Contract shall be considered a Best Value Contract if the Contractor’s bid is equal to or greater than \$61,000 for a single trade contract; or equal to or greater than \$297,500 for a multi-trade contract pursuant to MGO 33.07(7).

SECTION 102.12: EQUAL BENEFITS REQUIREMENT (SEC. 39.07, MGO)

Equal Benefits are not required. Delete this entire provision.

ARTICLE 104 SCOPE OF WORK

The work under this contract shall include, but is not limited to, replacing sanitary and storm sewer, removing and replacing concrete curb and gutter, sidewalk and drive aprons, excavation cut, crushed aggregate base course, and asphalt pavement as noted in the specifications and on the plans.

The Contractor shall view all sites prior to bidding to become familiar with the existing conditions. It will be the responsibility of the Contractor to work with the utilities located in the right of way to resolve conflicts during the construction process.

Darwin Road – Packers Avenue to International Lane

Work shall include replacing the sanitary sewer and storm sewer improvements. Curb & gutter, drive aprons and sidewalks shall be replaced where necessary to facilitate the storm sewer and sanitary sewer or are in poor condition. Darwin Road will be pulverized and shaped and the street will be paved with 2.5” Bituminous lower layer, 3 LT 58-28S and 2.0” Bituminous upper layer, 4 LT 58-28S.

SECTION 104.4 INCREASED OR DECREASED QUANTITIES

The Contractor shall note that some bid item quantities may increase or decrease based on what is encountered in the field. If the actual field conditions vary from the plan quantity, no additional compensation shall be given for increasing or decreasing quantities. Any overruns shall be paid for under the appropriate bid item(s) without any penalty or change to the bid price for the associated bid item. The Contractor shall not be reimbursed for any deletions to the contract. No change to the unit bid price will be allowed for changes to the quantities.

The Contractor shall note that the bid items for sidewalk removal and replacement may increase or decrease based on what is encountered in the field. It was anticipated that 106 SF of sidewalk removal and replacement would be required for each of the sanitary lateral replacements.

SECTION 104.10 CLEANING UP

Excess concrete from finishing operations and from spillage on adjacent sidewalk and curb & gutter shall be removed immediately. Excess concrete or mortar from the finishing operation and spillage into SASs and inlets shall be removed immediately.

SECTION 105.12 COOPERATION BY THE CONTRACTOR

The Contractor shall use care around existing trees, plantings, fences, walls, steps and driveways that are indicated on the plans to remain. Damage to these items during construction shall be repaired or replaced at the Contractor's expense. No trees, other than those shown on the plan to be removed, shall be cut without the approval of the Engineer and the City Forester; the abutting property owners shall be notified in accordance with the City's Administrative Procedure Memorandum No. 6-2.

The Contractor shall maintain access for property owners, mail delivery and garbage/recycling pickup for all properties in the project area. All private storm sewer discharges shall be maintained for all properties in the project area.

All commercial accesses on Darwin Street shall be maintained at all times except for when work is directly in front of the driveways. The Contractor shall coordinate with business owners for business deliveries.

SECTION 107.1 PUBLIC CONVENIENCE AND SAFETY

Access to businesses and commercial driveways shall be maintained at all times. The Contractor shall coordinate with parking lot property owners to maintain access and notify residents of access routes.

The Contractor shall properly barricade and light all work areas. Sidewalk forms, form pins and other items incidental to the work shall not be left or stored on the sidewalk or in the sidewalk area.

The Contractor shall backfill along both sides of the newly poured sidewalk immediately following removal of the sidewalk forms.

Engineer shall have the final decision on schedule of all work.

SECTION 107.12 RAILROAD – HIGHWAY GRADE SEPARATIONS AND APPROACHES, NEW RAILROAD CROSSINGS, AND OPERATION ON RAILROAD RIGHT-OF WAY

The company representative who may be consulted by Bidders and Contractors with regard to railroad requirements is Dave LeClaire of Canadian Pacific Railroad (CPR), at (612) 330-4556. Notice must be given to Dave LeClaire at least 72 hours prior to working within fifty feet of the Railroad Tracks, The Contractor shall obtain the authorization of CPR to work within fifty feet (50') of the railroad tracks prior to any work being done. Any time that work is being done within fifty feet (50') of the track, a CPR flag person must be present.

It shall be the responsibility of the Contractor to compensate the Railroad for the flag person requirements. Prior to any work within fifty feet (50') of the Railroad Tracks, the Contractor shall provide CPR an estimate of the time required to perform the necessary work within fifty feet (50') of the Railroad Tracks and the Contractor shall pre-pay CPR an estimated cost for the compensation for a flag person based on the estimated time required to perform all work within fifty feet (50') of the tracks and the current hourly rate of compensation charged by CPR for a flag person. In the event that the pre-paid amount for the flag person compensation exceeds the actual cost required for the compensation of the flag person, any excess pre-paid amount will be refunded to the Contractor. In the event that actual cost for compensation of the flag person exceeds the pre-paid estimate, the Contractor shall submit an additional pre-payment for the estimated additional cost for compensation of a flag person, prior to any work continuing within fifty feet (50') of the tracks.

Absolutely no staging of equipment or materials will be allowed within the railroad right-of-way.

If a Contractor violates any of these requirements, the Canadian Pacific Railroad reserves the right to remove and prohibit the Contractor from any further access or encroachment on the CPR right of way regardless of whether or not that access or encroachment is on, under, over, intentional or inadvertent until such time as the Contractor provides satisfactory assurances and measures to prevent any reoccurrence of such violation.

Contractor to confirm all requirements with Canadian Pacific Railway.

BID ITEM 10790 – RAILROAD INSURANCE

The Contractor shall provide special third party protection insurance for, and in behalf of, the Canadian Pacific Railroad per Section 107.12(c) Railroad Insurance Requirements of the City of Madison Standard Specifications.

The amount of insurance to be provided shall be limited to a combined single limit amount of Two Million Dollars (\$2,000,000) per occurrence for Bodily Injury Liability, Property Damage Liability, and Physical Damage to Property, with Six Million Dollars (\$6,000,000) aggregate for the term of the policy with respect to Bodily Injury Liability, Property Damage Liability and Physical Damage to Property.

Contractor to confirm all requirements with Canadian Pacific Railway.

SECTION 107.2 PROTECTION AND RESTORATION OF PROPERTY AND PROPERTY OWNERS

Care shall be taken not to disturb property irons, sod areas and retaining walls on private property. Sidewalk forms, form pins and other items incidental to the work shall, at no time, be placed on private property.

SECTION 107.6 DUST PROOFING

The Contractor shall take all necessary steps to control dust arising from operations connected with this contract. When ordered by the Engineer, the Contractor shall dust proof the construction area by using power sweepers and water. Dust proofing shall be incidental with operations connected with this contract.

SECTION 107.7 MAINTENANCE OF TRAFFIC

All signing and barricading shall conform to Part VI of the Federal Highways Administrations “Manual on Uniform Traffic Control Devices” (MUTCD), the State of Wisconsin Standard Facilities Development Manual (including Chapter 16 – Standard Detail Drawings) and the City of Madison Standards for sidewalk and bikeway closures.

The Contractor shall submit an acceptable Traffic Control Plan to the office of the City Traffic Engineer, a minimum of five (5) working days, prior to the pre-construction meeting. The Traffic Control Plan shall be sent to jschippa@cityofmadison.com. The Traffic Control Plan shall include any necessary signing and phasing schedule with the dates of lane closures. The Traffic Engineering Division will assist the contractor in determining acceptable lane closures and detours (if needed), if the preliminary Traffic Control plan is submitted to the office of the City Traffic Engineer, at least 10 working days prior to the pre-construction meeting.

Darwin Road may be closed to through traffic while the streets are under construction.

Maintain local and emergency vehicle access at all times.

Traffic Control shall be measured as a lump sum. Payment for the Traffic Control is full compensation for constructing, assembling, hauling, erecting, re-erecting, maintaining, restoring, and removing non-

permanent traffic signs, drums, barricades, tubular markers and similar control devices, including arrow boards, for providing, placing, and maintaining work zone. Maintaining shall include replacing damaged or stolen traffic control devices. Temporary pavement markings and electronic message boards shall be paid for as separate bid items. Traffic control to install temporary or permanent pavement markings shall be included in the Traffic Control Lump Sum Bid Item.

Contractor shall supply all necessary mounting hardware and supports for signing. This shall also include covering and uncovering any conflicting overhead signs during the project. Contractor shall display all signing so as to be easily viewed by all users. Contractor shall mount traffic control on posts or existing poles or drive posts whenever possible. Existing poles may be used with approval of Construction Engineer. Contractor shall inspect traffic control daily to ensure all traffic control remains in place during the project.

The traffic control plan may need to be altered as conditions change in the field or as unexpected conditions occur. This shall include relocating existing traffic control or providing additional traffic control. This should be considered incidental to providing traffic control for the project.

The work areas shall be backfilled, plated, or protected by traffic control devices during non-working hours. If steel plates are used, the Contractor shall notify the City of Madison Streets Division, 266-4681, one working day prior to placement of the plates.

Tubular markers used to separate traffic in opposite directions shall be per WISDOT S.D.D. 15C-11. Tubular markers used to shift traffic and placed between traffic operating in the same direction shall be white in color with yellow reflective tape.

Type A warning lights shall be installed on all barricades used in the project per State of Wisconsin S.D.D. 15C2-4B. Contractor shall also place Type C warning lights on any barrels used to taper traffic or lane closures.

All temporary inlet or structure plating for traffic control phasing shall be considered incidental to the traffic control bid item.

Maintain Access to all properties along the project at all times. This includes local residents, businesses and emergency vehicles. Notify residents and businesses in writing at least 72 hours prior to restricting access or closing any driveway.

Contractor shall place portable changeable message boards at least one week in advance of the start of work, notifying the public of the start of construction. Contractor shall locate the portable changeable message boards as directed by the Engineer.

Contractor shall notify the City of Madison Police Department, Fire Department, Madison Metro, and Traffic Engineering 48 hours in advance of all switchovers of traffic lanes and closures of streets. Notifications must be given by 4:00 P.M. on Thursday for any such work to be done on the following Monday. Notify Madison Metro one week prior to traffic switches, street closures, and reopening the road to through traffic for bus routing. Madison Metro contact is Tim Sobota (608) 261-4289.

Maintain sidewalk on one side at all times and both sides whenever possible. If sidewalk must be closed for construction purposes, contractor shall ensure that sidewalk on opposite side of the street is open and that all crosswalks at the end of the closed sidewalk block are fully open. Sidewalk closures shall be signed at the crosswalks prior to the closure. Sidewalk access to all businesses shall remain open from at least one end of a block at all times. Sidewalks shall be fully open during non-working hours except where necessary to enable sidewalk to cure.

Construction equipment and materials are not to be stored within the street right-of-way that is open to traffic during non-working hours.

Contractor is responsible for obtaining and installing temporary no parking signs to facilitate traffic control plan or as necessary to complete the work within the contract. The contractor shall contact John Villareal with the City of Madison Parking Utility (608-267-8756) at least 3 working days prior to needing the signs. Contractor shall post signs in accordance with the City of Madison Police Department Guidelines for temporary no parking restrictions for construction or special events. The guidelines can be found at the link listed below. This shall be considered incidental to the traffic control lump sum bid item.

http://www.cityofmadison.com/business/pw/documents/guidelines_temporarynoparkingrestrictions.pdf

The Contractor shall not remove traffic signs. For removal or replacement of traffic and parking signs, contact the City of Madison Traffic Engineering Field Operations, 1120 Sayle Street, 266-4767, 8:00 a.m. to 4:00 p.m., a minimum of 2 working days in advance of when any existing signs need to be removed. This service is provided free of charge. If the contractor removes the signs, the contractor will be billed for the reinstallation of, and any damage to, the signing equipment. The contractor shall notify The City of Madison Traffic Engineering Field Operations, 1120 Sayle Street, 266-4767 upon completion of final landscaping to have permanent signs reinstalled. The contractor shall expect a minimum of seven working days to have permanent signs reinstalled. The contractor shall leave in place all necessary traffic control until given notice by the construction engineer that permanent signing is in place and temporary traffic control may be removed.

Contact Jerry Schippa, Traffic Engineering Division, jschippa@cityofmadison.com, 267-1969, with any questions concerning these traffic control specifications.

SECTION 108.2 PERMITS

The City of Madison has obtained a City of Madison Erosion Control Permit and has submitted a DNR WRAPP Water Resources Application for Project Permit (formerly known as Notice of Intent (NOI) to obtain coverage under a Construction Site General Permit.

The Contractor shall meet the conditions of the permits by properly installing and maintaining the erosion control measures shown on the plans, specified in these Special Provisions, or as directed by the Construction Engineer or his designees. This work will be paid for under the appropriate contract bid items or, if appropriate items are not included in the contract, shall be paid for as Extra Work. A copy of the permit is available at the City of Madison, Engineering Division office.

This permit covers trench dewatering to a maximum of 70 gallons/minute from the project, provided appropriate control measures are in place. The City's obtaining this permit is not intended to be exhaustive of all permits that may be required to be obtained by the Contractor for construction of this project. It shall be the responsibility of the Contractor to identify and obtain any other permits needed for construction.

The Contractor may encounter contaminated soils and/or groundwater. The Contractor will be required to obtain a permit from the City of Madison for discharging to public sanitary.

The Contractor shall refer to section 210.6 Erosion Control Implementation and Enforcement for additional information on the requirements regarding this topic.

The City has applied for a permit from Canadian Pacific Railroad for the proposed sewer crossing of the railroad. Work shall not proceed on the railroad crossing until the City has obtained the permit from the Railroad.

SECTION 109.2 PROSECUTION OF THE WORK

The completion date shall be **October 15, 2019**. The total time for completion of this contract is **SEVENTY-FIVE (75) CALENDAR DAYS**.

The Contractor shall note that this project includes an expedited schedule and that the Contractor shall anticipate multiple crews as required to complete the work in the time frame provided and under the traffic restrictions outlined in these provisions.

Work shall begin only after the start work letter is received. The Contractor shall establish a mutually acceptable date with the City Engineer (contact the Construction Engineer at 266-4089) three (3) weeks in advance of the selected start date.

BID ITEM 20101 – EXCAVATION CUT

Removal of any existing small timber retaining walls or planters, landscaping borders and small shrubs shall be considered incidental to this bid item.

BID ITEM 20336 – PIPE PLUG

With regard to the City of Madison Standard Specifications for Public Works Construction Latest Edition Article 203.2(c), any pipe found in a trench that is less than 10" in diameter while installing a sewer facility shall be considered incidental to the pipe being installed.

Pipe plugs expected for this project will be for erosion control measures. Any inlet and associated pipe removed to install sanitary sewer shall have a temporary plug installed within the pipe to prevent soil and sediment laden trench water from entering the pipe.

Any pipe plugs required to abandon or remove sewer access structure (pipes directly connected to the structure) shall be considered incidental to abandoning or removing the structure regardless of the size of the pipe being abandoned.

SECTION 210.1(d) STREET SWEEPING

When required, either by the erosion control plan or the Construction Engineer, the Contractor shall perform mechanical street sweeping on all streets or paved surfaces affected by construction equipment, hauling or related construction activities that result in mud tracking or siltation. Mechanical street sweeping shall be completed as directed by the Construction Engineer and shall remove all loose material to the satisfaction of the Construction Engineer. Depending on site conditions, construction activities, and hauling methods utilized by the Contractor mechanical street sweeping may be required multiple times throughout the day with an absolute minimum that all streets are clean at the end of the work day. Areas not accessible by mechanical street sweepers may require hand scraping with shovels.

SECTION 210.6 EROSION CONTROL IMPLEMENTATION AND ENFORCEMENT

Timely action regarding the maintenance of erosion control practices is critical to compliance with the City of Madison's land disturbance permits as issued both by the WDNR and the City. To allow the City to be assured of compliance with these permits, and federal, state and local laws, the Contractor shall be required to proceed in the following manner with regard to the maintenance of these practices.

In the event an erosion control practice is determined by the Engineer or their designee to require maintenance, or if the terms of the erosion control permit are not being met, the Engineer shall order the Contractor, in writing, to maintain the erosion control practice/device or comply with the terms of the permit. The contractor shall have forty eight (48) hours to complete that work and provide documentation that it has been completed to the Engineer.

Failure to complete the work within the forty eight (48) hours shall result in any or all of the following actions by the Engineer:

- 1) The Contractor shall be charged one (1) day of liquidated damages for failure to complete the work during the ordered timeframe and an additional day of liquidated damages for each twenty

four (24) hour period that passes after the initial forty eight (48) hours during which time the ordered work is not completed.

2) At the Engineer's discretion, the work ordered may be completed by City Forces. In this case, the Contractor shall be charged the liquidated damages as described in 1 above and shall be charged the full cost of City Forces responding to complete the ordered work.

3) At the Engineer's discretion, work on the project as a whole may be suspended under Section 109.6 until such time as the Contractor completes the originally ordered work. In this case, the Contractor shall still be charged liquidated damages as described in 1 above. Additionally, days of work will continue to be charged during the suspension of work. If this results in the Contractor failing to complete the project within the allotted contract time then additional liquidated damages shall be charged.

Notwithstanding the foregoing, the failure to comply with an order under this Section may constitute a default under Section 109.10.

The Engineer's decision under this Section may be reviewed under Section 105.2.

BID ITEM 30208 – HAND FORMED CURB & GUTTER

When placing Hand Formed Curb & Gutter adjacent to existing trees, the Contractor shall minimize the excavation necessary for the curb to be installed. The excavated area shall be limited to a maximum of 6 Inches behind the back of curb. Payment for hand formed concrete curb and gutter is full compensation for furnishing any materials necessary, and for furnishing all labor, tools, equipment, materials, and incidentals necessary to complete the work. The Contractor shall coordinate work with City Forestry as required by the standard specifications.

BID ITEM 40366 – REBUILD INLET - RESURFACING

Reconnection of all leads shall be considered incidental including private connections and shall include all repair of leads damaged from inlet removal.

ARTICLE 500 SEWERS AND SEWER STRUCTURES

The sewer designer for this project is Daniel Olivares. He may be contacted at (608) 261-9285 or daolivares@cityofmadison.com.

SANITARY SEWER GENERAL

This project consists of the installation of 1250' of 8" SDR-35 sanitary main pipe. Sanitary sewer pipe work shall include installing new sewer at the sizes and locations that are specified on the plan set and in accordance with the Standard Specifications.

ASTM D3034 SDR-35 sewer main and lateral as called for on the plan set shall be payable under Sanitary Sewer Main (Bid Item 50301) and Sanitary Lateral (Bid Item 50354).

Laterals that are shown on the plans as 8" in diameter shall be paid for as 8" PVC Sanitary Sewer Pipe (Bid Item 50301)

All new sanitary sewer access structures shall include the Neenah R-1550 R-1050 Frame w/ City of Madison Logo Lid 1550-0054(see S.D.D. 5.7.16 of the City of Madison Standard Specifications for Public Works Construction Latest edition). All new sewer main connections may be factory cored and shall be included in the structure. All existing lateral and main connections shall be field cored to accommodate existing conditions and shall be compensated under BID ITEM 50791 SANITARY SEWER TAP. All sewer main and/or laterals not slated for replacement that are damaged during the installation of a

structure shall be replaced by the Contractor and shall be considered incidental to the project. All benches and flowlines shall have a smooth trowel finish.

It is advised that the Contractor visit the site prior to bidding to determine the type of trench protection that will be necessary for the sanitary sewer main installation.

Per the City of Madison Standard Specifications for sanitary sewer lateral construction on street reconstruction projects, Contractors are encouraged to begin installation of sanitary lateral pipe at the proposed sewer main. If Contractor starts excavation for the lateral at the property line, it shall be at the Contractor's risk. A portion of the sanitary sewer laterals were located and surveyed prior to design. Laterals located are marked on the plan as Lateral Located (TYP). If tree conflicts are encountered during the sanitary lateral replacement process, contractors are instructed to follow the new policy set in the Standard Specifications for Public Works Construction, Latest edition. No Utility Line Openings (ULOs) will be granted for the inability to locate the sanitary lateral at the property line. Any extra sidewalk removal will not be compensated to the Contractor looking for an existing sanitary lateral at the property line.

Contractors shall have a locator device on-site if they intend to start laying lateral pipe at the property line to minimize the amount of extra sidewalk removal. Each sanitary lateral shall have a maximum of 4 sidewalk squares removed and replaced. No additional compensation shall be awarded beyond this amount for the replacement of a sewer lateral. If laterals called for reinstatement on the plans are to be plugged under the direction of the engineer on-site, contractors are required to use a sonde device to confirm that the laterals are not active. In addition, contractor will be required to provide a videos of the laterals being abandoned prior to them being abandoned.

Sanitary lateral locations are based upon the City television reports and the City records. Proposed sanitary lateral locations near trees are subject to change based upon data obtained in the field and property owner involvement. Excavation near trees shall comply with Article 107.13 of the Standard Specifications. If 5 ft of separation from the tree to the excavation cannot be maintained, lateral replacement shall stop at the curb upon approval by the construction engineer. The Construction Engineer will make the determination whether lateral replacement will need to stop at the curb.

Pipe Removal within the same trench as the proposed sewer is considered incidental to the new pipe being installed including asbestos cement and cast-in-place pipe removal.

Any utility tunneling required shall be considered incidental to the pipe being installed.

STORM SEWER AND STRUCTURES GENERAL

Storm sewer pipe work shall include point pipe repairs, adjusting, rebuilding, and/or protecting the existing storm sewer system to install the sanitary sewer.

Point Repairs called out on plans and schedule to repair joint separations and/or pipe failures, as identified on TV report, are to include saw-cutting existing pipe, installing up to four feet (4') of new RCP pipe with two concrete collars and select backfill. To be paid under Bid Items 50211 SELECT BACKFILL FOR STORM SEWER, 50401 12 INCH TYPE I RCP STORM SEWER PIPE, 50402 15 INCH TYPE I RCP STORM SEWER PIPE, 50405 24 INCH TYPE I RCP STORM SEWER PIPE, AND 50499 CONCRETE COLLAR.

SECTION 502.1(c) DEWATERING

DEWATERING

This section describes dewatering the site during construction or working with the water on-site in a manner that allows the project to be constructed in accordance with the plans and specifications. This item includes the dewatering of groundwater, surface water runoff, and trench dewatering, both clean and potentially contaminated.

The contractor is responsible for all work, materials and equipment required to comply with permit conditions to dewater the site. At a minimum, pump water into a settling tank to settle solids prior to discharge into the storm sewer for clean water and into the designated sanitary sewer for potentially contaminated water.

BID ITEM 50255 – UTILITY TRENCH PATCH TYPE IV

Apply the “Type IV” trench patch to all sanitary main trenches.

BID ITEM 50354 - SANITARY SEWER LATERAL

Sanitary sewer laterals shown on the construction plans were located by City television inspection and records only.

Where the existing sanitary sewer laterals are being extended to connect to the new sanitary sewer main (being installed in a different location as the existing main), pipe plugs shall be required to plug the existing sanitary sewer main on both sides of the old lateral location. The pipe plugs shall be considered incidental to the bid price for SANITARY SEWER LATERAL. All work associated with this bid item shall comply with Article 503 of the Standard Specifications.

Per the City of Madison Standard Specifications for sanitary sewer lateral construction on street reconstruction projects, Contractors are encouraged to begin installation of sanitary lateral pipe at the proposed sewer main. If Contractor starts excavation for the lateral at the property line, it shall be at the Contractor’s risk. No Utility Line Openings (ULOs) will be granted for the inability to locate the sanitary lateral at the property line. Any extra sidewalk removal will not be compensated to the Contractor looking for an existing sanitary lateral at the property line. Contractors are encouraged to have a locator device on-site if they intend to start laying lateral pipe at the property line to minimize the amount of extra sidewalk removal.

Proposed sanitary lateral locations near trees are subject to change based upon data obtained in the field and property owner involvement. Excavation near trees shall comply with Article 107.13 of the Standard Specifications. If 5 feet of separation from the tree to the excavation cannot be maintained, lateral replacement shall stop at the curb upon approval by the construction Engineer.

BID ITEM 50356 - RECONNECT SANITARY LATERAL

The first 5 feet of pipe shall be included with this bid item regardless of pipe type or fittings used (SDR 35). Beyond 5 feet shall be paid for separately per Bid Item 50354 SANITARY SEWER LATERAL.

The first 5 feet of sewer lateral pipe/ fittings measured from the sewer main shall be considered the reconnect for all sewer lateral reconstructions. Lateral connections connecting to sewer access structures shall be paid for separately as a sanitary tap. 5’ of lateral pipe is not considered incidental to the sanitary tap connection.

BID ITEM 50390 - SEWER ELECTRONIC MARKERS

With regard to the City of Madison Standard Specifications for Public Works Construction Latest Edition Article 503.3(c), each sanitary lateral shall have a minimum of two (2) electronic markers with the City providing the Contractor with the required number of electronic markers. For sanitary laterals which only include the installation of a wye, a marker ball shall be installed directly above the wye connection to the main.

BID ITEM 50801 – UTILITY LINE OPENING (ULO)

The work under this item shall be completed in accordance with Article 508 of the Standard Specifications for Public Works Construction. It is the discretion of the contractor to locate utilities by either a trench

excavation or by a pothole technique. However, the contractor shall not be compensated more than once for multiple utilities located within a maximum distance of five (5) feet long.

BID ITEM 90030 – BORE & JACK 8” DIAMETER SANITARY SEWER

DESCRIPTION

A. General

Work under this item shall include the installation and material cost to BORE AND JACK 8” DIAMETER SANITARY SEWER main with casings. The sanitary sewer shall be installed by boring and jacking where included with this bid item is a suitable sized “casing pipe”. The casing pipe must be sized by the contractor in order for the inner sanitary sewer lateral to properly fit within the casing pipe. All costs for furnishing and installing the steel casing pipe, casing spacers, access and receiving pits, and all work necessary to push the casing pipe shall be included.

Included in this item is the excavation and backfilling of the receiving pits. Disposal of the excess material shall be by the Contractor off site at a location to be determined by the Contractor. Backfilled material shall meet City of Madison Standard Specifications for Public Works Construction - 2018 Edition. Necessary work and materials to adequately secure the pits with full cover or security fencing shall be incidental to this bid item. The 8” diameter sewer being installed within the casing will be included within this bid item along with any ULOs needed to ensure no utilities are damaged with this work.

All ULOs shall be completed before work begins to ensure clearance of all utilities.

The Contractor is informed that the casing pipe specified shall be at a minimum of 24” diameter or as large as deemed necessary by the contractor to successfully complete the work in accordance with the construction plans.

B. Materials

Bore and Jack shall include all materials necessary to install the 8” sanitary sewer pipe in accord with the requirements above. A casing pipe included with this item shall be in accord with the following:

- ASTM specification A139 Grade B or AWWA specification C200
- Outside diameter as specified by the Contractor
- Not coated or cathodically protected, no hydrostatic testing required
- 0.4375” minimum thickness (See chart on Sheet U-1 for casing thickness requirements)
- Specified minimum yield strength, SMYS, of at least 35,000 psi
- New and unused pipe
- Straight and round pipe
- Beveled ends for butt welding

The Contractor shall submit the following to the Engineer for approval prior to ordering of materials and the start of construction:

- Certificate of compliance for the steel casing pipe
- Materials for sand of pea gravel
- Materials for casing spacers and distances between spacers
- Materials and methods for bulkheading the casing ends

C. Construction Methods

Contractor will be allowed to use wood blocking and/or pipe spaces to suspend the pipe in casing pipe to obtain the proper design slope. Both will be considered acceptable installation methods. The design slope will be verified by a City surveyor and if the slope is back-pitched or nor at an acceptable slope, the Construction Engineer will require the pipe be adjusted.

Blocking Method:

Prior to installing pipe in the casing, a set of **four** wood blocks shall be strapped to **both** ends of the pipe **five feet (5')** from **each end**. The blocks shall be set so that the pipe does not touch the casing. Pipe joints shall be made outside of the casing. Sand or Pea gravel shall be washed or blown into the casing to the spring line of the pipe to provide bedding under the pipe.

Pipe Spacers Method:

Non-Centered stainless Steel spacers (PSI S8GN-2 http://www.pipelineseal.com/pdf_lit/csem&bg.pdf or approved equivalent) shall be installed in the casing pipe at varying to the new sewer main to set the sewer main to the desired slope. Spacers shall be installed in accordance with the manufacturer's specifications with maximum spacing of 8'.

The untrenched construction shall be performed by dry auger boring and jacking. Water jacking for excavation of the soil is not allowed. The use of water to facilitate removal of spoil is permitted. The untrenched construction shall extend beneath the railroad tracks to the limits shown on the plan set.

For the casing installation, the bore hole diameter shall be essentially the same as the outside diameter of the pipe. In soft, unstable soil, the auger shall be inside the casing, but no undersized, so as not to create a void between the casing and the soil. If voids should develop or if the bore hole diameter is greater than the outside diameter of the pipe by more than approximately 1 inch, the voids shall be pressure grouted.

Connection of adjacent lengths of steel pipe shall be done by continuous, circumferential, field butt welding in accordance with AWWA C206. The connection shall result in a straight and true casing with a watertight seal.

The conduit pipe shall be installed on line and grade through the casing pipe. Install approved casing spacers at the approved distances. Fill the annular space between the casing and carrier pipe with the approved material (sand or pea gravel).

Take care to ensure that developed thrust pressures do not disturb existing utilities in or around the bore pit area. Any damage to utilities- public or private will be the responsibility of the contractor to repair.

METHOD OF MEASUREMENT

BORE AND JACK 8" DIAMETER SANITARY SEWER shall be measured by the lineal foot for successful completion of the 8" sanitary sewer pipe and larger casing pipe as described above which shall include all materials, equipment, labor, and incidentals necessary to complete the work.

BASIS OF PAYMENT

BORE AND JACK 8" DIAMETER SANITARY SEWER shall be measured as described above and shall be paid for at the contract price which shall be full compensation for all work, materials, labor and incidentals required to complete the work as set forth in the description.

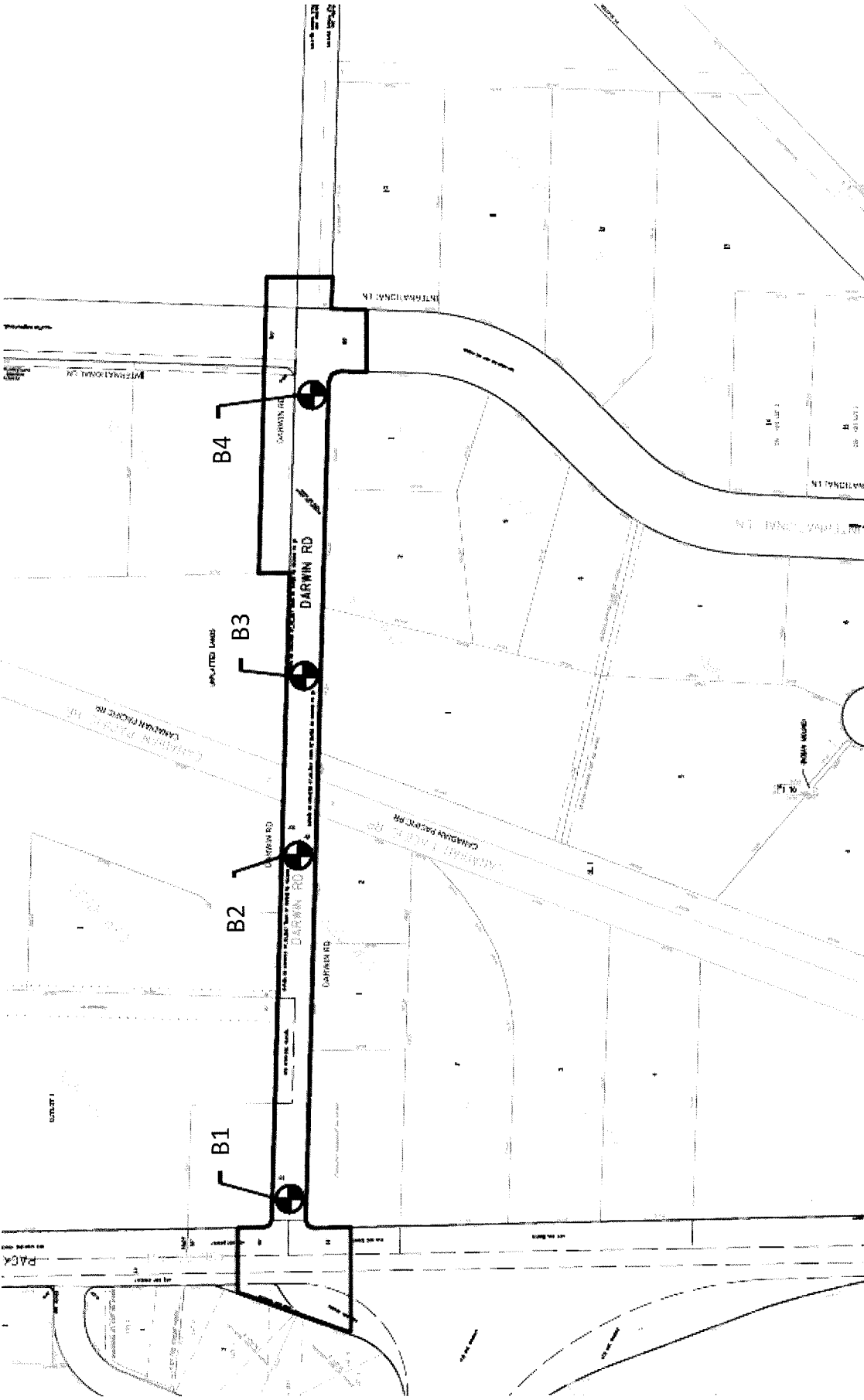

Legend

⊕ Denotes Boring Location

Notes

1. Soil borings performed by Badger State Drilling in December 2017
2. Boring locations are approximate.

Scale: Reduced

Soil Boring Location Plan
Darwin Road
Madison, WI

CGC, Inc.

Date:
 12/2017

Job No.
 C17051-45



LOG OF TEST BORING

Project Darwin Road
160'E of Packers, 10'N of CL
 Location Madison, WI

Boring No. 1
 Surface Elevation (ft) 895±
 Job No. C17051-45
 Sheet 1 of 1

2921 Perry Street, Madison, WI 53713 (608) 288-4100, FAX (608) 288-7887

| SAMPLE | | | | | Depth (ft) | VISUAL CLASSIFICATION and Remarks | SOIL PROPERTIES | | | | |
|--------|------|-----------|-------|----|------------|---|---------------------|---|----|----|----|
| No. | TYPE | Rec (in.) | Moist | N | | | qu (qa) (tsf) | W | LL | PL | LI |
| | | | | | 0 | 5 in. Asphalt Pavement/8 in. Base Course | | | | | |
| 1 | | 7 | M | 8 | 0-8 | FILL: Loose Brown Sand with Silt and Gravel | | | | | |
| 2 | | 14 | M | 11 | 8-11 | Medium Dense to Dense, Brown Fine to Medium SAND, Some Silt and Gravel, Scattered Cobbles & Boulders (SM) | | | | | |
| 3 | | 18 | M | 14 | 11-14 | | | | | | |
| 4 | | 18 | M | 12 | 14-17 | | | | | | |
| 5 | | 18 | M | 39 | 17-39 | | | | | | |
| 6 | | 18 | M | 44 | 39-44 | | | | | | |
| | | | | | 44-15 | | End Boring at 15 ft | | | | |
| | | | | | 15-20 | Backfilled with bentonite chips and asphalt patch (N 43° 07.736', W 89° 21.276') | | | | | |

WATER LEVEL OBSERVATIONS

While Drilling NW Upon Completion of Drilling _____
 Time After Drilling _____
 Depth to Water _____
 Depth to Cave in _____

GENERAL NOTES

Start 12/8/17 End 12/8/17
 Driller BSD Chief MC Rig CME-55
 Logger DC Editor ESF
 Drill Method 2-1/4" HSA; Autohammer

The stratification lines represent the approximate boundary between soil types and the transition may be gradual.



LOG OF TEST BORING

Project Darwin Road
740'E of Packers, 10'N of CL
 Location Madison, WI

Boring No. 2
 Surface Elevation (ft) 887±
 Job No. C17051-45
 Sheet 1 of 1

2921 Perry Street, Madison, WI 53713 (608) 288-4100, FAX (608) 288-7887

| SAMPLE | | | | | VISUAL CLASSIFICATION and Remarks | SOIL PROPERTIES | | | | |
|--------|------|--------------|-------|----|--|-----------------|---------------------|---|----|----|
| No. | TYPE | Rec (in.) | Moist | N | | Depth (ft) | qu (qa) (tsf) | W | LL | PL |
| | | | | | 5.5 in. Asphalt Pavement/8 in. Base Course | | | | | |
| 1 | █ | 0 | | 5 | Medium Stiff, Brown Lean CLAY, Trace Sand (CL) | | | | | |
| 2 | █ | 18 | M | 4 | (0.75) | | | | | |
| 3 | █ | 16 | M | 8 | Loose to Dense, Brown Fine to Medium SAND, Some Silt and Gravel, Scattered Cobbles & Boulders (SM) | | | | | |
| 4 | █ | 18 | M | 12 | | | | | | |
| 5 | █ | 18 | M | 17 | | | | | | |
| 6 | █ | 18 | M | 39 | | | | | | |
| | | | | | End Boring at 15 ft Backfilled with bentonite chips and asphalt patch (N 43° 07.734', W 89° 21.138') | | | | | |

WATER LEVEL OBSERVATIONS

While Drilling ∇ NW Upon Completion of Drilling _____
 Time After Drilling _____
 Depth to Water _____
 Depth to Cave in _____

GENERAL NOTES

Start 12/8/17 End 12/8/17
 Driller BSD Chief MC Rig CME-55
 Logger DC Editor ESF
 Drill Method 2-1/4" HSA; Autohammer

The stratification lines represent the approximate boundary between soil types and the transition may be gradual.



LOG OF TEST BORING

Project Darwin Road
735'E of Packers, 10'N of CL
 Location Madison, WI

Boring No. 2X
 Surface Elevation (ft) 887±
 Job No. C17051-45
 Sheet 1 of 1

2921 Perry Street, Madison, WI 53713 (608) 288-4100, FAX (608) 288-7887

| SAMPLE | | | | | VISUAL CLASSIFICATION and Remarks | SOIL PROPERTIES | | | | |
|--------|------|--------------|-------|-------|--|-----------------|---------------------------------|---|----|----|
| No. | TYPE | Rec (in.) | Moist | N | | Depth (ft) | q _u (qa) (tsf) | W | LL | PL |
| | | | | | 5 in. Asphalt Pavement/8 in. Base Course | | | | | |
| 1 | | 18 | M | 28 | FILL: Medium Dense Brown Sand with White Sandstone Gravel | | | | | |
| 2 | | 0 | M | 50/2" | End Boring at 3.7 ft due to spoon refusal on unknown, <i>unmarked</i> obstruction Backfilled with soil cuttings and asphalt patch Moved 5'E and performed Boring 2 | | | | | |

WATER LEVEL OBSERVATIONS

GENERAL NOTES

While Drilling ∇ NW Upon Completion of Drilling _____
 Time After Drilling _____
 Depth to Water _____
 Depth to Cave in _____

Start 12/8/17 End 12/8/17
 Driller BSD Chief MC Rig CME-55
 Logger DC Editor ESF
 Drill Method 2-1/4" HSA; Autohammer

The stratification lines represent the approximate boundary between soil types and the transition may be gradual.



LOG OF TEST BORING

Project Darwin Road
475'W of International, 10'N of CL
 Location Madison, WI

Boring No. 3
 Surface Elevation (ft) 880±
 Job No. C17051-45
 Sheet 1 of 1

2921 Perry Street, Madison, WI 53713 (608) 288-4100, FAX (608) 288-7887

| SAMPLE | | | | | VISUAL CLASSIFICATION and Remarks | SOIL PROPERTIES | | | | |
|--------|--------------|-------|----|---------------|--------------------------------------|--|---|----|----|----|
| No. | Rec (in.) | Moist | N | Depth (ft) | | qu (qa) (tsf) | W | LL | PL | LI |
| | | | | | X | 6 in. Asphalt Pavement/3.5 in. Base Course | | | | |
| 1 | 10 | M | 9 | | / | Medium Stiff, Brown Lean CLAY (CL) | (0.75) | | | |
| 2 | 16 | M | 4 | | / | Stiff and Sandy Near 4 ft | (1.25) | | | |
| 3 | 16 | M | 29 | | . | Medium Dense, Light Brown Fine to Coarse SAND, Some Gravel, Trace Silt (SP) | | | | |
| 4 | 18 | M | 13 | | . | Medium Dense to Very Dense, Brown Fine to Medium SAND, Some Silt and Gravel, Scattered Cobbles & Boulders (SM) | | | | |
| 5 | 18 | M | 28 | | . | | | | | |
| 6 | 18 | M | 62 | | . | | | | | |
| | | | | 15 | | - | End Boring at 15 ft | | | |
| | | | | | | - | Backfilled with bentonite chips and asphalt patch (N 43° 07.730', W 89° 21.015') | | | |

| WATER LEVEL OBSERVATIONS | GENERAL NOTES |
|---|---|
| While Drilling <input checked="" type="checkbox"/> NW Upon Completion of Drilling _____ Time After Drilling _____ Depth to Water _____ Depth to Cave in _____ | Start <u>12/8/17</u> End <u>12/8/17</u> Driller <u>BSD</u> Chief <u>MC</u> Rig <u>CME-55</u> Logger <u>DC</u> Editor <u>ESF</u> Drill Method <u>2-1/4" HSA; Autohammer</u> |
| The stratification lines represent the approximate boundary between soil types and the transition may be gradual. | |



LOG OF TEST BORING

Project Darwin Road
145'W of International, 10'N of CL
 Location Madison, WI

Boring No. 4
 Surface Elevation (ft) 871±
 Job No. C17051-45
 Sheet 1 of 1

2921 Perry Street, Madison, WI 53713 (608) 288-4100, FAX (608) 288-7887

| SAMPLE | | | | | VISUAL CLASSIFICATION and Remarks | SOIL PROPERTIES | | | | |
|--------|--------------|-------|----|---------------|--|---------------------|---|----|----|----|
| No. | Rec (in.) | Moist | N | Depth (ft) | | qu (qa) (tsf) | W | LL | PL | LI |
| | | | | | 5 in. Asphalt Pavement/8.5 in. Gravel Base | | | | | |
| 1 | 16 | M | 8 | | Stiff, Brown Lean CLAY (CL) | (1.25) | | | | |
| 2 | 14 | M | 11 | | Medium Dense, Dark Brown Clayey Fine SAND (SC) | | | | | |
| 3 | 18 | M | 16 | | Medum Dense to Dense, Brown Fine to Medium SAND, Some Silt and Gravel, Scattered Cobbles and Boulders (SM) | | | | | |
| 4 | 16 | M | 20 | | | | | | | |
| 5 | 18 | M | 43 | | | | | | | |
| 6 | 18 | M | 40 | | | | | | | |
| | | | | 15 | End Boring at 15 ft | | | | | |
| | | | | | Backfilled with bentonite chips and asphalt patch (N 43° 07.730', W 89° 20.942') | | | | | |

| WATER LEVEL OBSERVATIONS | GENERAL NOTES |
|--|---|
| While Drilling <u>∇</u> <u>NW</u> Upon Completion of Drilling _____ Time After Drilling _____ Depth to Water _____ Depth to Cave in _____ | Start <u>12/8/17</u> End <u>12/8/17</u> Driller <u>BSD</u> Chief <u>MC</u> Rig <u>CME-55</u> Logger <u>DC</u> Editor <u>ESF</u> Drill Method <u>2-1/4" HSA; Autohammer</u> |
| The stratification lines represent the approximate boundary between soil types and the transition may be gradual. | |

SECTION E: BIDDERS ACKNOWLEDGEMENT

**DARWIN ROAD RESURFACING WITH UTILITIES ASSESSMENT DISTRICT – 2019
CONTRACT NO. 8124**

Bidder must state a Unit Price and Total Bid for each item. The Total Bid for each item must be the product of quantity, by Unit Price. The Grand Total must be the sum of the Total Bids for the various items. In case of multiplication errors or addition errors, the Grand Total with corrected multiplication and/or addition shall determine the Grand Total bid for each contract. The Unit Price and Total Bid must be entered numerically in the spaces provided. All words and numbers shall be written in ink.

1. The undersigned having familiarized himself/herself with the Contract documents, including Advertisement for Bids, Instructions to Bidders, Form of Proposal, City of Madison Standard Specifications for Public Works Construction - 2018 Edition thereto, Form of Agreement, Form of Bond, and Addenda issued and attached to the plans and specifications on file in the office of the City Engineer, hereby proposes to provide and furnish all the labor, materials, tools, and expendable equipment necessary to perform and complete in a workmanlike manner the specified construction on this project for the City of Madison; all in accordance with the plans and specifications as prepared by the City Engineer, including Addenda Nos. _____ through _____ to the Contract, at the prices for said work as contained in this proposal. (Electronic bids submittals shall acknowledge addendum under Section E and shall not acknowledge here)
2. If awarded the Contract, we will initiate action within seven (7) days after notification or in accordance with the date specified in the contract to begin work and will proceed with diligence to bring the project to full completion within the number of work days allowed in the Contract or by the calendar date stated in the Contract.
3. The undersigned Bidder or Contractor certifies that he/she is not a party to any contract, combination in form of trust or otherwise, or conspiracy in restraint of trade or commerce or any other violation of the anti-trust laws of the State of Wisconsin or of the United States, with respect to this bid or contract or otherwise.
4. I hereby certify that I have met the Bid Bond Requirements as specified in Section 102.5. *(IF BID BOND IS USED, IT SHALL BE SUBMITTED ON THE FORMS PROVIDED BY THE CITY. FAILURE TO DO SO MAY RESULT IN REJECTION OF THE BID).*
5. I hereby certify that all statements herein are made on behalf of _____ (name of corporation, partnership, or person submitting bid) a corporation organized and existing under the laws of the State of _____ a partnership consisting of _____; an individual trading as _____; of the City of _____ State of _____; that I have examined and carefully prepared this Proposal, from the plans and specifications and have checked the same in detail before submitting this Proposal; that I have fully authority to make such statements and submit this Proposal in (its, their) behalf; and that the said statements are true and correct.

SIGNATURE

TITLE, IF ANY

Sworn and subscribed to before me this _____ day of _____, 20_____.

(Notary Public or other officer authorized to administer oaths)
My Commission Expires _____

Bidders shall not add any conditions or qualifying statements to this Proposal.

SECTION F: BEST VALUE CONTRACTING

DARWIN ROAD RESURFACING WITH UTILITIES ASSESSMENT DISTRICT – 2019 CONTRACT NO. 8124

Best Value Contracting

1. The Contractor shall indicate the non-apprenticeable trades used on this contract.

2. Madison General Ordinance (M.G.O.), 33.07(7), does provide for some exemptions from the active apprentice requirement. Apprenticeable trades are those trades considered apprenticeable by the State of Wisconsin. Please check applicable box if you are seeking an exemption.
 - Contractor has a total skilled workforce of four or less individuals in all apprenticeable trades combined.
 - No available trade training program; The Contractor has been rejected by the only available trade training program, or there is no trade training program within 90 miles.
 - Contractor is not using an apprentice due to having a journey worker on layoff status, provided the journey worker was employed by the contractor in the past six months.
 - First-time Contractor on City of Madison Public Works contract requests a onetime exemption but intends to comply on all future contracts and is taking steps typical of a “good faith” effort.
 - Contractor has been in business less than one year.
 - Contractor doesn’t have enough journeyman trade workers to qualify for a trade training program in that respective trade.
 - An exemption is granted in accordance with a time period of a “Documented Depression” as defined by the State of Wisconsin.

3. The Contractor shall indicate on the following section which apprenticeable trades are to be used on this contract. Compliance with active apprenticeship, to the extent required by M.G.O. 33.07(7), shall be satisfied by documentation from an applicable trade training body; an apprenticeship contract with the Wisconsin Department of Workforce Development or a similar agency in another state; or the U.S Department of Labor. This documentation is required prior to the Contractor beginning work on the project site.
 - The Contractor has reviewed the list and shall not use any apprenticeable trades on this project.

LIST APPRENTICABLE TRADES (check all that apply to your work to be performed on this contract)

- BRICKLAYER
- CARPENTER
- CEMENT MASON / CONCRETE FINISHER
- CEMENT MASON (HEAVY HIGHWAY)
- CONSTRUCTION CRAFT LABORER
- DATA COMMUNICATION INSTALLER
- ELECTRICIAN
- ENVIRONMENTAL SYSTEMS TECHNICIAN / HVAC SERVICE TECH/HVAC INSTALL / SERVICE
- GLAZIER
- HEAVY EQUIPMENT OPERATOR / OPERATING ENGINEER
- INSULATION WORKER (HEAT & FROST)
- IRON WORKER
- IRON WORKER (ASSEMBLER, METAL BLDGS)
- PAINTER & DECORATOR
- PLASTERER
- PLUMBER
- RESIDENTIAL ELECTRICIAN
- ROOFER & WATER PROOFER
- SHEET METAL WORKER
- SPRINKLER FITTER
- STEAMFITTER
- STEAMFITTER (REFRIGERATION)
- STEAMFITTER (SERVICE)
- TAPER & FINISHER
- TELECOMMUNICATIONS (VOICE, DATA & VIDEO) INSTALLER-TECHNICIAN
- TILE SETTER

SECTION G: BID BOND

KNOW ALL MEN BY THESE PRESENT, THAT Principal and Surety, as identified below, are held and firmly bound unto the City of Madison, (hereinafter referred to as the "Obligee"), in the sum of five per cent (5%) of the amount of the total bid or bids of the Principal herein accepted by the Obligee, for the payment of which the Principal and the Surety bind themselves, their heirs, executors, administrators, successors and assigns, jointly and severally, firmly by these presents.

The conditions of this obligation are such that, whereas the Principal has submitted, to the City of Madison a certain bid, including the related alternate, and substitute bids attached hereto and hereby made a part hereof, to enter into a contract in writing for the construction of:

DARWIN ROAD RESURFACING WITH UTILITIES ASSESSMENT DISTRICT – 2019 CONTRACT NO. 8124

1. If said bid is rejected by the Obligee, then this obligation shall be void.
2. If said bid is accepted by the Obligee and the Principal shall execute and deliver a contract in the form specified by the Obligee (properly completed in accordance with said bid) and shall furnish a bond for his/her faithful performance of said contract, and for the payment of all persons performing labor or furnishing materials in connection therewith, and shall in all other respects perform the agreement created by the acceptance of said bid, then this obligation shall be void.

If said bid is accepted by the Obligee and the Principal shall fail to execute and deliver the contract and the performance and payment bond noted in 2. above executed by this Surety, or other Surety approved by the City of Madison, all within the time specified or any extension thereof, the Principal and Surety agree jointly and severally to forfeit to the Obligee as liquidated damages the sum mentioned above, it being understood that the liability of the Surety for any and all claims hereunder shall in no event exceed the sum of this obligation as stated, and it is further understood that the Principal and Surety reserve the right to recover from the Obligee that portion of the forfeited sum which exceed the actual liquidated damages incurred by the Obligee.

The Surety, for value received, hereby stipulates and agrees that the obligations of said Surety and its bond shall be in no way impaired or affected by an extension of the time within which the Obligee may accept such bid, and said Surety does hereby waive notice of any such extension.

IN WITNESS WHEREOF, the Principal and the Surety have hereunto set their hands and seals, and such of them as are corporations have caused their corporate seals to be hereto affixed and these presents to be signed by their proper officers, on the day and year set forth below.

Seal PRINCIPAL

Name of Principal

By

Date

Name and Title

Seal SURETY

Name of Surety

By

Date

Name and Title

This certifies that I have been duly licensed as an agent for the above company in Wisconsin under National Provider No. _____ for the year _____, and appointed as attorney in fact with authority to execute this bid bond and the payment and performance bond referred to above, which power of attorney has not been revoked.

Date

Agent Signature

Address

City, State and Zip Code

Telephone Number

NOTE TO SURETY & PRINCIPAL

The bid submitted which this bond guarantees shall be rejected if the following instrument is not attached to this bond:

Power of Attorney showing that the agent of Surety is currently authorized to execute bonds on behalf of the Surety, and in the amounts referenced above.

Certificate of Biennial Bid Bond

| |
|---|
| TIME PERIOD - VALID (FROM/TO) |
| NAME OF SURETY |
| NAME OF CONTRACTOR |
| CERTIFICATE HOLDER <p style="text-align: center;">City of Madison, Wisconsin</p> |

This is to certify that a biennial bid bond issued by the above-named Surety is currently on file with the City of Madison.

This certificate is issued as a matter of information and conveys no rights upon the certificate holder and does not amend, extend or alter the coverage of the biennial bid bond.

Cancellation: Should the above policy be cancelled before the expiration date, the issuing Surety will give thirty (30) days written notice to the certificate holder indicated above.

Signature of Authorized Contractor Representative

Date

SECTION H: AGREEMENT

THIS AGREEMENT made this _____ day of _____ in the year Two Thousand and Eighteen between _____ hereinafter called the Contractor, and the City of Madison, Wisconsin, hereinafter called the City.

WHEREAS, the Common Council of the said City of Madison under the provisions of a resolution adopted _____, and by virtue of authority vested in the said Council, has awarded to the Contractor the work of performing certain construction.

NOW, THEREFORE, the Contractor and the City, for the consideration hereinafter named, agree as follows:

1. **Scope of Work.** The Contractor shall, perform the construction, execution and completion of the following listed complete work or improvement in full compliance with the Plans, Specifications, Standard Specifications, Supplemental Specifications, Special Provisions and contract; perform all items of work covered or stipulated in the proposal; perform all altered or extra work; and shall furnish, unless otherwise provided in the contract, all materials, implements, machinery, equipment, tools, supplies, transportation, and labor necessary to the prosecution and completion of the work or improvements:

DARWIN ROAD RESURFACING WITH UTILITIES ASSESSMENT DISTRICT – 2019 CONTRACT NO. 8124

2. **Completion Date/Contract Time.** Construction work must begin within seven (7) calendar days after the date appearing on mailed written notice to do so shall have been sent to the Contractor and shall be carried on at a rate so as to secure full completion SEE SPECIAL PROVISIONS, the rate of progress and the time of completion being essential conditions of this Agreement.
3. **Contract Price.** The City shall pay to the Contractor at the times, in the manner and on the conditions set forth in said specifications, the sum of _____ (\$_____) Dollars being the amount bid by such Contractor and which was awarded to him/her as provided by law.
4. **Affirmative Action.** In the performance of the services under this Agreement the Contractor agrees not to discriminate against any employee or applicant because of race, religion, marital status, age, color, sex, disability, national origin or ancestry, income level or source of income, arrest record or conviction record, less than honorable discharge, physical appearance, sexual orientation, gender identity, political beliefs, or student status. The Contractor further agrees not to discriminate against any subcontractor or person who offers to subcontract on this contract because of race, religion, color, age, disability, sex, sexual orientation, gender identity or national origin.

The Contractor agrees that within thirty (30) days after the effective date of this agreement, the Contractor will provide to the City Affirmative Action Division certain workforce utilization statistics, using a form to be furnished by the City.

If the contract is still in effect, or if the City enters into a new agreement with the Contractor, within one year after the date on which the form was required to be provided, the Contractor will provide updated workforce information using a second form, also to be furnished by the City. The second form will be submitted to the City Affirmative Action Division no later than one year after the date on which the first form was required to be provided.

The Contractor further agrees that, for at least twelve (12) months after the effective date of this contract, it will notify the City Affirmative Action Division of each of its job openings at facilities in Dane County for which applicants not already employees of the Contractor are to be considered. The notice will include a job description, classification, qualifications and application procedures

and deadlines. The Contractor agrees to interview and consider candidates referred by the Affirmative Action Division if the candidate meets the minimum qualification standards established by the Contractor, and if the referral is timely. A referral is timely if it is received by the Contractor on or before the date started in the notice.

Articles of Agreement Article I

The Contractor shall take affirmative action in accordance with the provisions of this contract to insure that applicants are employed, and that employees are treated during employment without regard to race, religion, color, age, marital status, disability, sex, sexual orientation, gender identity or national origin and that the employer shall provide harassment free work environment for the realization of the potential of each employee. Such action shall include, but not be limited to, the following: employment, upgrading, demotion or transfer, recruitment or recruitment advertising, layoff or termination, rates of pay or other forms of compensation and selection for training including apprenticeship insofar as it is within the control of the Contractor. The Contractor agrees to post in conspicuous places available to employees and applicants notices to be provided by the City setting out the provisions of the nondiscrimination clauses in this contract.

Article II

The Contractor shall in all solicitations or advertisements for employees placed by or on behalf of the Contractors state that all qualified or qualifiable applicants will be employed without regard to race, religion, color, age, marital status, disability, sex, sexual orientation, gender identity or national origin.

Article III

The Contractor shall send to each labor union or representative of workers with which it has a collective bargaining agreement or other contract or understanding a notice to be provided by the City advising the labor union or worker's representative of the Contractor's equal employment opportunity and affirmative action commitments. Such notices shall be posted in conspicuous places available to employees and applicants for employment.

Article V

The Contractor agrees that it will comply with all provisions of the Affirmative Action Ordinance of the City of Madison, including the contract compliance requirements. The Contractor agrees to submit the model affirmative action plan for public works contractors in a form approved by the Affirmative Action Division Manager.

Article VI

The Contractor will maintain records as required by Section 39.02(9)(f) of the Madison General Ordinances and will provide the City Affirmative Action Division with access to such records and to persons who have relevant and necessary information, as provided in Section 39.02(9)(f). The City agrees to keep all such records confidential, except to the extent that public inspection is required by law.

Article VII

In the event of the Contractor's or subcontractor's failure to comply with the Equal Employment Opportunity and Affirmative Action Provisions of this contract or Section 39.03 and 39.02 of the Madison General Ordinances, it is agreed that the City at its option may do any or all of the following:

1. Cancel, terminate or suspend this Contract in whole or in part.

2. Declare the Contractor ineligible for further City contracts until the Affirmative Action requirements are met.
3. Recover on behalf of the City from the prime Contractor 0.5 percent of the contract award price for each week that such party fails or refuses to comply, in the nature of liquidated damages, but not to exceed a total of five percent (5%) of the contract price, or five thousand dollars (\$5,000), whichever is less. Under public works contracts, if a subcontractor is in noncompliance, the City may recover liquidated damages from the prime Contractor in the manner described above. The preceding sentence shall not be construed to prohibit a prime Contractor from recovering the amount of such damage from the non-complying subcontractor.

Article VIII

The Contractor shall include the above provisions of this contract in every subcontract so that such provisions will be binding upon each subcontractor. The Contractor shall take such action with respect to any subcontractor as necessary to enforce such provisions, including sanctions provided for noncompliance.

Article IX

The Contractor shall allow the maximum feasible opportunity to small business enterprises to compete for any subcontracts entered into pursuant to this contract. (In federally funded contracts the terms "DBE, MBE and WBE" shall be substituted for the term "small business" in this Article.)

5. Substance Abuse Prevention Program Required. Prior to commencing work on the Contract, the Contractor, and any Subcontractor, shall have in place a written program for the prevention of substance abuse among its employees as required under Wis. Stat. Sec. 103.503.
6. **Contractor Hiring Practices.**

Ban the Box - Arrest and Criminal Background Checks. (Sec. 39.08, MGO)

This provision applies to all prime contractors on contracts entered into on or after January 1, 2016, and all subcontractors who are required to meet prequalification requirements under MGO 33.07(7)(l), MGO as of the first time they seek or renew pre-qualification status on or after January 1, 2016. The City will monitor compliance of subcontractors through the pre-qualification process.

- a. **Definitions.** For purposes of this section, "Arrest and Conviction Record" includes, but is not limited to, information indicating that a person has been questioned, apprehended, taken into custody or detention, held for investigation, arrested, charged with, indicted or tried for any felony, misdemeanor or other offense pursuant to any law enforcement or military authority.

"Conviction record" includes, but is not limited to, information indicating that a person has been convicted of a felony, misdemeanor or other offense, placed on probation, fined, imprisoned or paroled pursuant to any law enforcement or military authority.

"Background Check" means the process of checking an applicant's arrest and conviction record, through any means.

- b. **Requirements.** For the duration of this Contract, the Contractor shall:

1. Remove from all job application forms any questions, check boxes, or other inquiries regarding an applicant's arrest and conviction record, as defined herein.

2. Refrain from asking an applicant in any manner about their arrest or conviction record until after conditional offer of employment is made to the applicant in question.
3. Refrain from conducting a formal or informal background check or making any other inquiry using any privately or publicly available means of obtaining the arrest or conviction record of an applicant until after a conditional offer of employment is made to the applicant in question.
4. Make information about this ordinance available to applicants and existing employees, and post notices in prominent locations at the workplace with information about the ordinance and complaint procedure using language provided by the City.
5. Comply with all other provisions of Sec. 39.08, MGO.

c. Exemptions: This section shall not apply when:

1. Hiring for a position where certain convictions or violations are a bar to employment in that position under applicable law, or
2. Hiring a position for which information about criminal or arrest record, or a background check is required by law to be performed at a time or in a manner that would otherwise be prohibited by this ordinance, including a licensed trade or profession where the licensing authority explicitly authorizes or requires the inquiry in question.

To be exempt, Contractor has the burden of demonstrating that there is an applicable law or regulation that requires the hiring practice in question, if so, the contractor is exempt from all of the requirements of this ordinance for the position(s) in question.

**DARWIN ROAD RESURFACING WITH UTILITIES ASSESSMENT DISTRICT – 2019
CONTRACT NO. 8124**

IN WITNESS WHEREOF, the Contractor has hereunto set his/her hand and seal and the City has caused this contract to be sealed with its corporate seal and to be executed by its Mayor and City Clerk on the dates written below.

Countersigned:

| | | | |
|---------|------|--------------|------|
| | | _____ | |
| | | Company Name | |
| _____ | Date | _____ | Date |
| Witness | | President | |
| _____ | Date | _____ | Date |
| Witness | | Secretary | |

CITY OF MADISON, WISCONSIN

Provisions have been made to pay the liability that will accrue under this contract.

Approved as to form:

| | | | |
|------------------|------|---------------|------|
| _____ | Date | _____ | Date |
| Finance Director | | City Attorney | |
| _____ | Date | _____ | Date |
| Witness | | Mayor | |
| _____ | Date | _____ | Date |
| Witness | | City Clerk | |

SECTION I: PAYMENT AND PERFORMANCE BOND

KNOW ALL MEN BY THESE PRESENTS, that we _____
as principal, and _____
Company of _____ as surety, are held and firmly bound unto the City of
Madison, Wisconsin, in the sum of _____ (\$_____) Dollars, lawful money of the United
States, for the payment of which sum to the City of Madison, we hereby bind ourselves and our
respective executors and administrators firmly by these presents.

The condition of this Bond is such that if the above bounden shall on his/her part fully and faithfully
perform all of the terms of the Contract entered into between him/herself and the City of Madison for the
construction of:

**DARWIN ROAD RESURFACING WITH UTILITIES ASSESSMENT DISTRICT – 2019
CONTRACT NO. 8124**

in Madison, Wisconsin, and shall pay all claims for labor performed and material furnished in the
prosecution of said work, and save the City harmless from all claims for damages because of negligence
in the prosecution of said work, and shall save harmless the said City from all claims for compensation
(under Chapter 102, Wisconsin Statutes) of employees and employees of subcontractor, then this Bond is
to be void, otherwise of full force, virtue and effect.

Signed and sealed this _____ day of _____

Countersigned:

Company Name (Principal)

Witness

President Seal

Secretary

Approved as to form:

Surety Seal
 Salary Employee Commission

City Attorney

By _____
Attorney-in-Fact

This certifies that I have been duly licensed as an agent for the above company in Wisconsin under
National Producer Number _____ for the year _____, and appointed as attorney-in-fact
with authority to execute this payment and performance bond which power of attorney has not been
revoked.

Date

Agent Signature